

# OVERMAT

THE FLOOR TECHNICIANS

## SERVICE MANUAL

### FLOOR FINISHING MACHINE

**XL 450 (17650)**

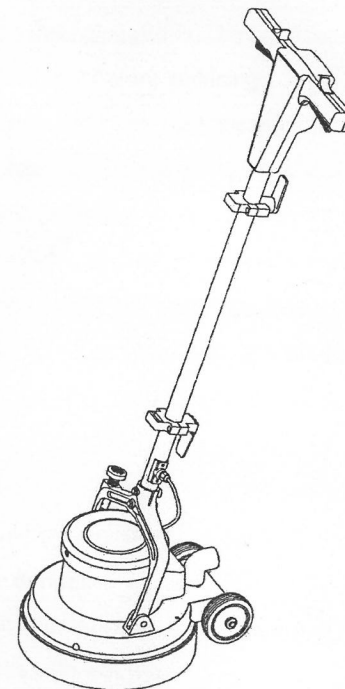

Overmat Industries BV Scharlo 11 5165 NG Waspik The Netherlands  
Tel. +31 (0) 416 31 77 88 Fax +31 (0) 416 31 35 61 Internet: [www.overmat.nl](http://www.overmat.nl) E-mail: [info@overmat.nl](mailto:info@overmat.nl)

# ***XL 450 FLOOR FINISHING MACHINE***

## **GENERAL SAFELY INSTRUCTION**

**To reduce the risk of fire, electric shock or injury, please observe the following safely instruction!**

1. The voltage must concur with that given on the machines data plate.
2. The appliance must be grounded: if the socket is improper, must change the socket or .increase the interim adapter, the socket and adapter must accord with the local legal rule.
3. Use indoors only.
4. There can't be incidentals in the working area, and there are well illuminated and good ventilation.
5. Don't use in areas where flammable or explosive substance. Such as gasoline.
6. Don't leave appliance when plugged in; Unplug from outlet when not in use, install or remove the brush/pad and before servicing.
7. Check the cord regularly, don't use with damaged cord or plug; If appliance is not working as it should has been dropped, damaged, left outdoors, or dropped into water, return it to a service center.
8. Don't pull or carry by cord, use cord as a handle, run appliance over cord, close a door on cord, keep cord away from heated surfaces, oil, sharp edges and corners.
9. Don't unplug by pulling on cord; Turn off all controls before unplugging.
10. Keep hair, loose clothing, fingers, and all parts of body away from openings and moving parts.
11. To reduce the risk of fire, use only commercially available floor cleaners and waxes.
12. When not in use, should store it carefully. Don't allow to be used as toy by children, so as not to cause the danger.
13. To avoid electric shock, please store appliance in a dry place, don't drench with rain, only clean the appliance with wet wiper.
14. The appliance may only be serviced and maintenance by customer services shops with legal authorization who are approved by manufacturer.

# XL 450 FLOOR FINISHING MACHINE

## ASSEMBLY DRAWING

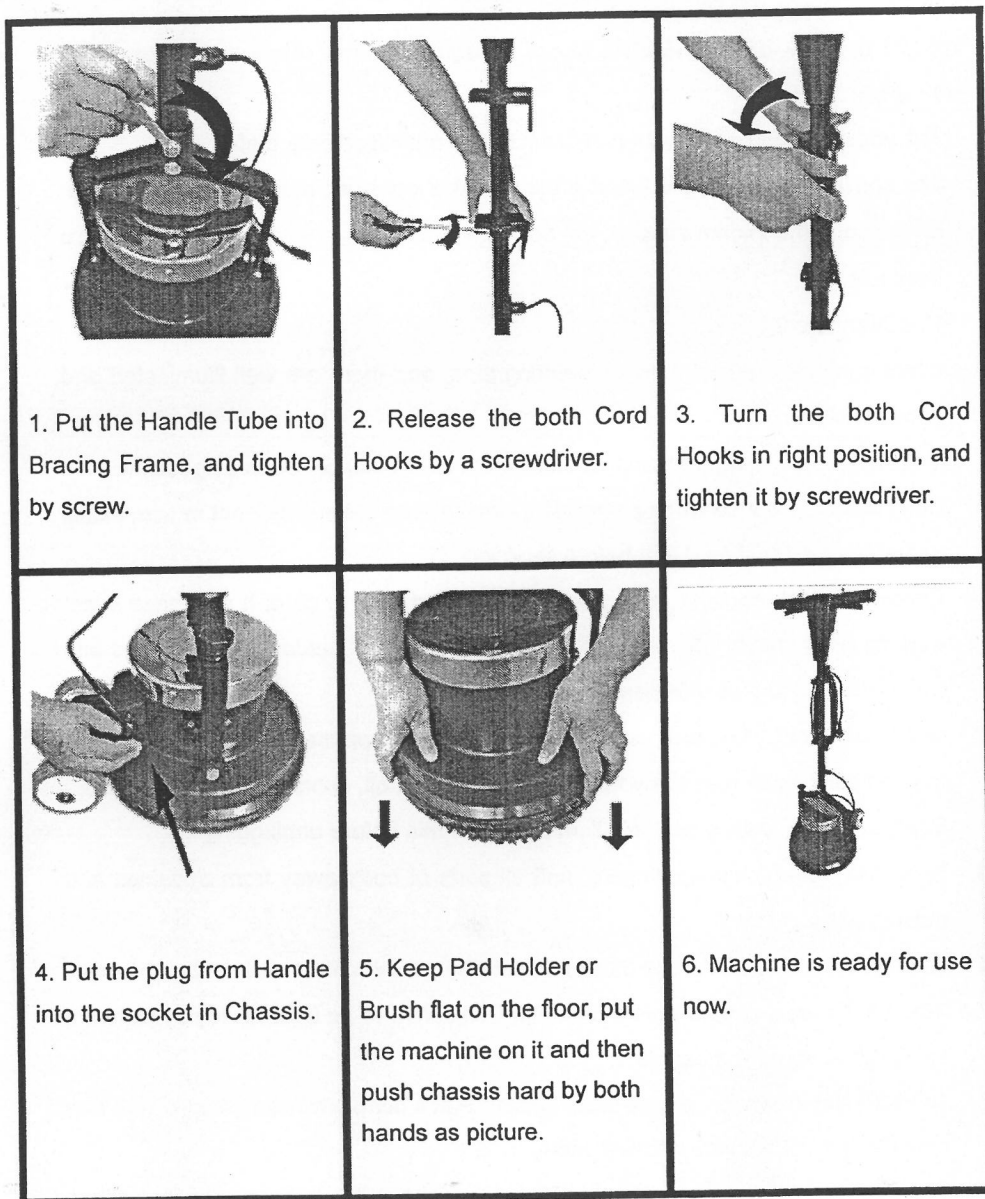

# XL 450 FLOOR FINISHING MACHINE

## ASSEMBLY DRAWING

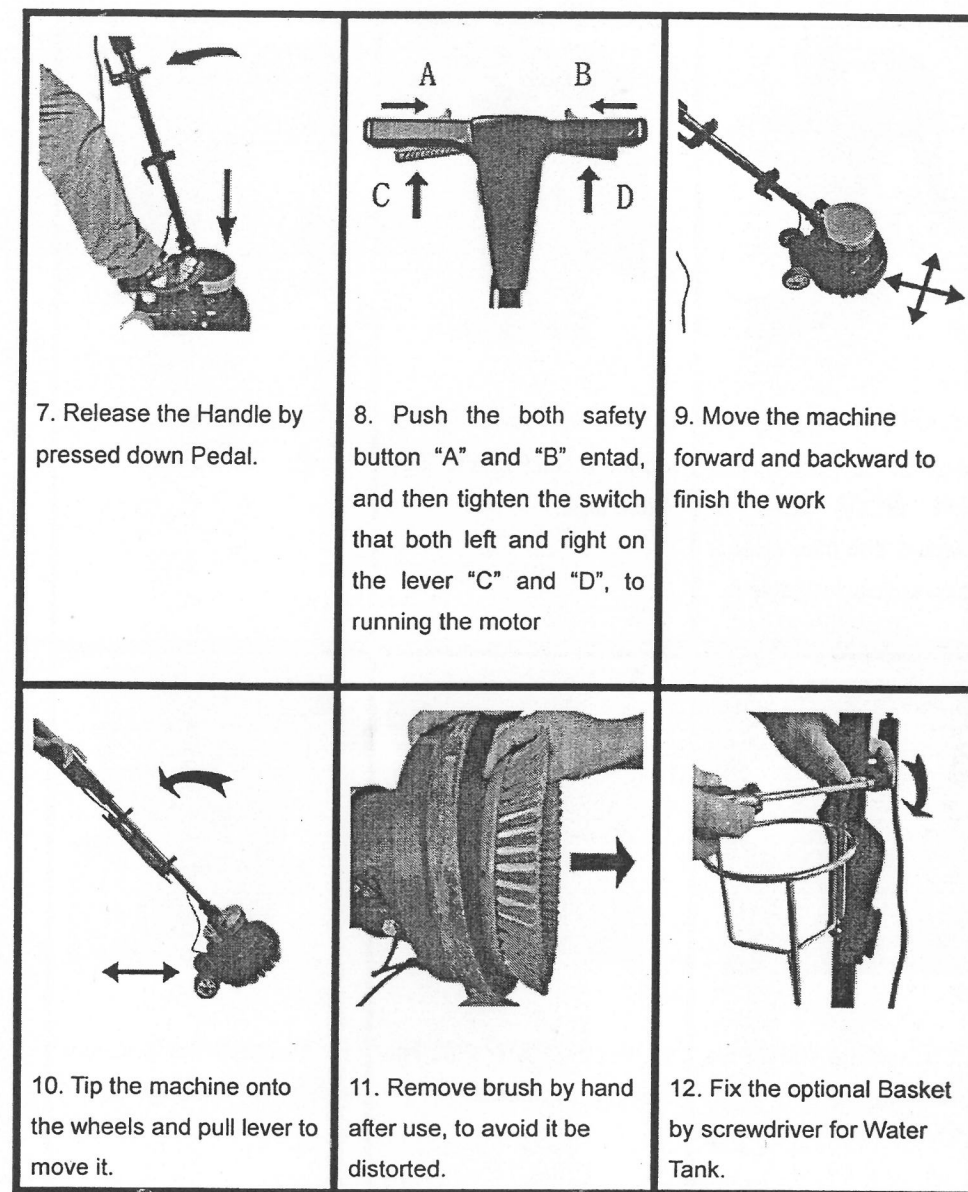

# XL 450 FLOOR FINISHING MACHINE

## ASSEMBLY DRAWING

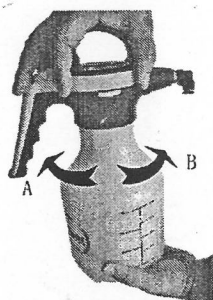

13. Open the Watering Pot by turn the top clockwise as B, fill it by water or detergent, and then close it by turn anticlockwise as A.

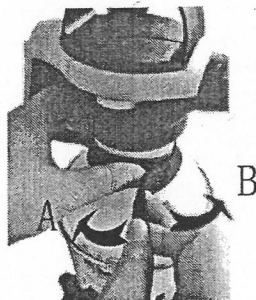

14. Put the Watering Pot into the Basket, and fix it by Velcro tape.

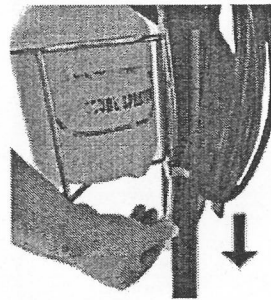

15. Put the Water Pipe through Basket.

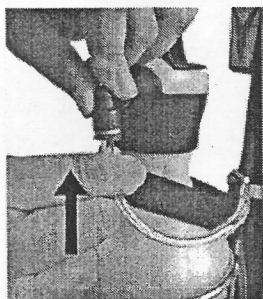

16. Connect the Water Pipe to Watering Pot

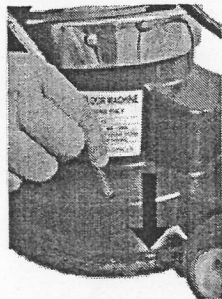

17. Put the Water Pipe into the hole on Chassis

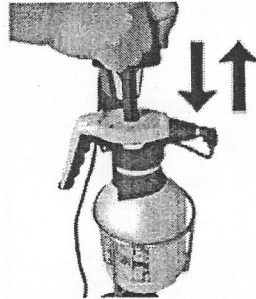

18. Increase the pressure inside the Watering Pot.

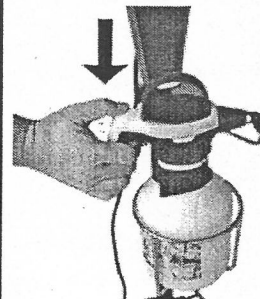

19. Press the button to spurted water into the floor.

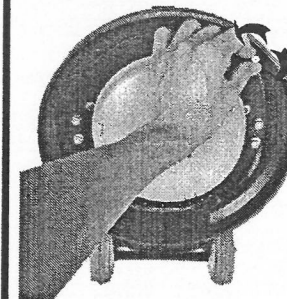

20. Spray angle can be adjusted by rotating Nozzle.



21. Release the pressure by push valve as below after job is completed.

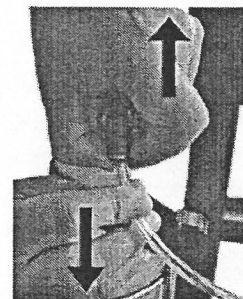

22. Push the fastener up, and pull the Water Pipe out at the same time.

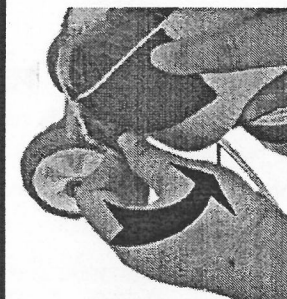

23. Splash Guard can be joined with Velcro.

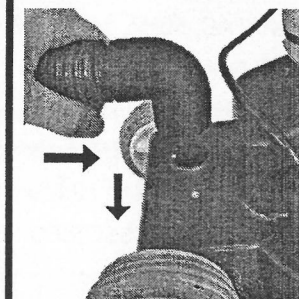

24. Connect the Floor Machine and Vacuum Cleaner by a Right Angle Joint.

# XL 450 FLOOR FINISHING MACHINE

## ASSEMBLY DRAWING



## XL 450 FLOOR FINISHING MACHINE

### CAUTION:

The voltage must concur with that given on the machines data plate.

### OPERATING INSTRUCTIONS

1. Before plugged in, must assemble pad holder or brush.
2. Must keeping the handle on the highest point, prevent the handle from dropping; cause the danger that people or anything.
3. Always wear shoes when using the appliance.
4. When not in use, remove pad holder or brush, avoid the pad holder or brush being warped.
5. Please clean the Nozzle after use.

### PURPOSE AND SPECIFICATIONS

This floor Machine design for residential use and the main purpose are strip, wash, buff, sand, refinish and dry clean your carpets.

#### Specifications of machine:

**MOTOR:** induction type motor (no carbon brushes to wear out)

220-240V AC, 50HZ, 1400RPM

**CABLE:** 6meter, 3G0.75mm<sup>2</sup>

**NET WEIGHT:** 17.20kgs

**HEIGHT WITH BRUSH:** 1.12m

**SPEED:** 150RPM with additional motion due to brush holder pad design

#### STANDARD ACCESSORIES

Please refer to the manual for the proper floor treatment and use of accessories.

1), carpet brush (Black bristle) Part No. 30103-01-2001

Use with Dry detergent, the brush can clean carpet softly.

2), Floor brush (green-white) Part No. 30103-01-2002

This brush is used to clean ceramic and concrete and many tough stains.

3), Pad holder Part No. 30103-01-2003

This holder is used to hold all types of floor pads.

4), white pad Part No. 90094A

This pad is used to polishing.

## XL 450 FLOOR FINISHING MACHINE

### MAINTENANCE

1. Be careful when using the machine, dropping, unreasonable bumping or rough handing may result in damage to the balance and counterweight system; Wrap your cord loosely around the two hooks on the handle.
2. Keep the machine cleaning, remove brushes after use, and clean it with wet wiper.
3. When pad, pad holder or brush were wear out, replace it.
4. Periodic lubrication using light oil is recommended at the motor bearings.
5. The common trouble and solution (Disconnect power cord before servicing)

Trouble Diagnosis		
Problem	Possible Cause	Action
Machine will not run	1. Not firmly plugged into plug 2. No voltage in plug 3. Malfunction for start capacitor	1. Plug unit firmly 2. Check fuse or breaker 3. Replace it
Machine Bounces	1. Using brush on dry surface without dry shampoo or wet shampoo 2. Brush or pad holder not properly in place (not make pad holder or brush level)	1. Apply necessary shampoo dry or wet 2. Place it properly (make pad holder or brush level)
Bracing Frame jammed	1. Not lubricated enough	1. Clean it with dry cloth and add lubricant.

### WARRANTY AND SERVICES

Within 6 months form the date of purchase if our floor washers are found faulty not due to human factors and verified by our company's or our authorized distributor's technician, the machine will be repaired and the faulty parts will be replaced at no charge.

The following happenings are excluded from our warranty.

1, Damages caused by improper use. 2, Damages caused by own disassembly or own alteration. 3, Damages caused by rough or careless handling. 4, Wrong voltage being used. 5, Damages caused by accidents or natural disasters.

**When** our machine is found faulty please contact our company or our authorized distributor's service department, if our machine is within the warranty period. However the user is advised to contact the above for proper service even the machine is beyond the warranty.

◆ **CAUTION:** Don't disassemble the machine by yourself.

◆ **CAUTION:** Warranty only valid for 6 months.

# XL 450 FLOOR FINISHING MACHINE

## DRAWING OF FLOOR FINISHING MACHINE

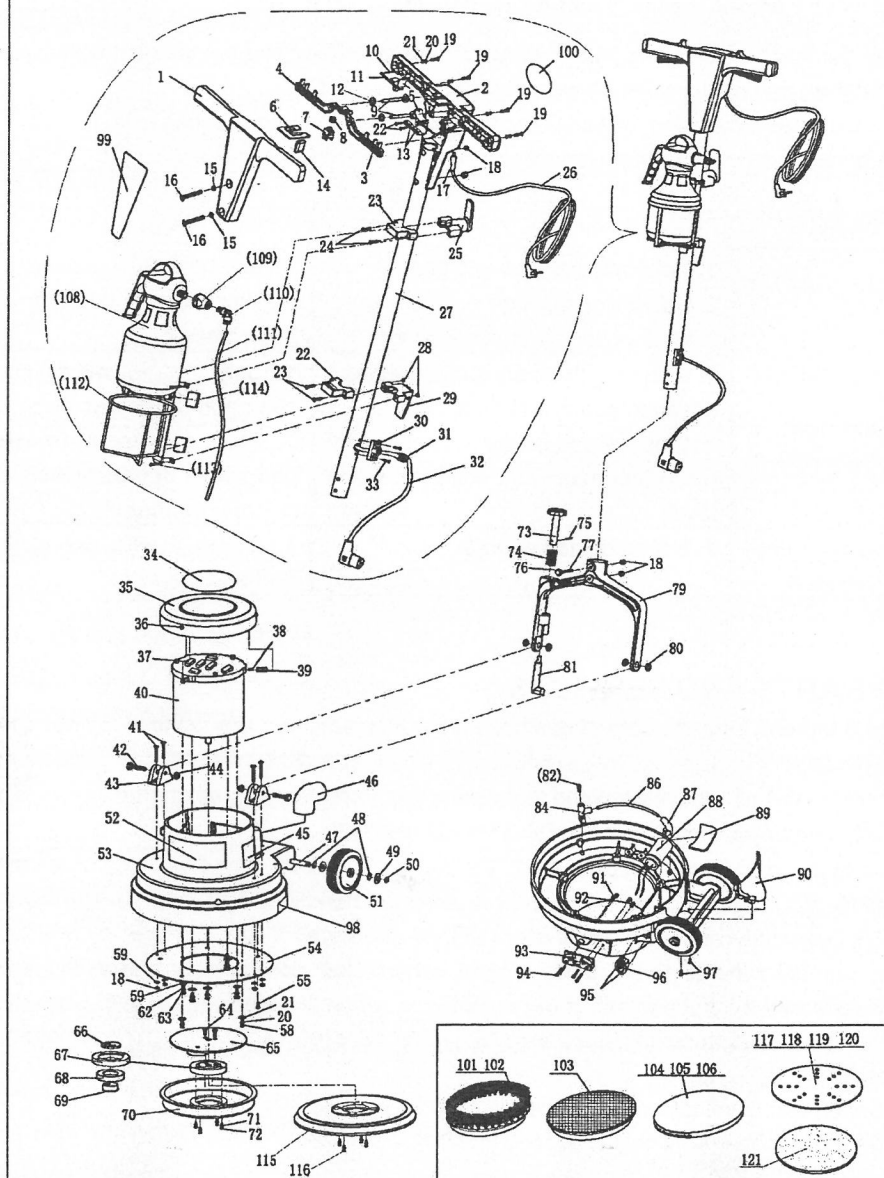

# XL 450 FLOOR FINISHING MACHINE

## PARTS LIST OF FLOOR FINISHING MACHINE

No.	Parts Code	Parts Name	Q'ty
1	30106-01-1003	Front Half of "T" Handle	1
2	30106-01-1004	Rear Half of "T" Handle	1
3	30106-01-1005	Lever Left	1
4	30106-01-1006	Lever Right	1
5	30106-01-1007	Safety Button	2
6	30101-01-1009A	Switch Plate A	1
7	30101-01-1008A	Power Switch	1
8	30106-01-1029	Spring A	1
9	80701003	Pin Ø6×50	2
10	90002	Pin Ø2.35×30	2
11	30106-01-1027	Spring B	2
12	80301028W	Flat Washer Ø6×14×1	4
13	30101-01-1017	Cord Clamp	2
14	30118-01-1022	Block	1
15	80302002S	Flat Washer Ø6×18×2.0	5
16	80102039S	Screw M6×45	2
17	30101-01-1024	Cord Protection	1
18	80401001S	Nut M6	9
19	80102013	Screw M5×25	8
20	80303003S	Elastic Washer Ø5	12
21	80301003S	Flat Washer Ø5×10×1	10
22	80106012S	Screw ST3.5×16	4
23	30106-01-1009	Cord Hooks Holder	2
24	80102026	Screw M5×30	4
25	30106-01-1010A	Quick Release Cord Hooks	1
26	30103-01-1024	Cord 3 X 0.752 X 6m	1
26'	30103-02-1024	Cord 18AWG X 3C X 19Ft.	1'
27	30119-01-1011	Tube	4
28	80402004	Nut M5	4

## XL 450 FLOOR FINISHING MACHINE

No.	Parts Code	Parts Name	Q'ty
29	30106-01-1010	Cord Hooks	1
30	30106-01-1014	Waterproof Joint Housing	1
31	30104-01-1071	Waterproof Joint PG9	1
32	30119-01-1012-1	Angle Plug Cord	1
32'	30119-01-1012-2	Angle Plug Cord	1'
33	80110001	Rivet Ø5×12	2
34	30101-01-3028	Trade Mark	1
35	30106-01-1023	Motor Cover	1
36	80102053S	Screw M4×6	3
37	30103-01-1040	Sponge Pad	3
38	80105014	Screw M4×16	4
39	30119-01-1017	Female Threaded Bolt	3
40	30103-01-1002	Motor 220-240V~50Hz	1
40'	30103-01-1002A	Motor 115V~60Hz	1
41	801110111S	Screw M6×35	4
42	80201036	Screw M8 X 35	2
43	30119-01-1005	Bracing Frame Holder	2
44	80401002S	Nut M8	2
45	30119-01-3015A	Data Plate 220V	1
45'	30119-01-3015B	Data Plate 110V	1
46	30119-01-1015	Right Angle Joint	1
47	30103-01-1035	Alex	1
48	80304007	Wave Washer Ø10.5	4
49	80301013S	Level Washer Ø10×22×2	4
50	80305002	Circlip Φ10	2
51	30103-01-1005	Wheel	2
52	30101-01-3003	Trade Mark	1
53	30119-01-1001	Chassis	1
54	30119-01-1106	Supporting Plate	1
55	80106008S	Screw ST4.8×16	3

## XL 450 FLOOR FINISHING MACHINE

No.	Parts Code	Parts Name	Q'ty
58	801020012S	Screw M5×16	3
59	80301005W	Flat Washer Ø6×12×1.6	8
62	80303004W	Elastic Washer Ø6	4
63	80201014W	Bolt M6×14	4
64	80101018	Screw M6 X 20	2
65	30103-01-1030	Plate With Counterweights Assy.	1
66	30103-01-1028	A Washer	1
67	30103-01-1029	Bearing Box	1
68	80501030	Bearing 6006-2RS	1
69	30103-01-1026	Bearing Core	1
70	30103-01-1025	Brush Holder Pad	1
71	80303002S	Elastic Washer Ø4	4
72	80102004	Elastic Washer Ø5	4
73	30119-01-1003-2	Pedal	1
74	30119-01-1008	Spring	1
75	80701022	Pin Ø3×14	1
76	80301008S	Flat Washer Ø6×15×1	2
77	80201035	Bolt M6×55	2
79	30119-01-1002	Bracing Frame	1
80	30119-01-1009	Lining	4
81	30119-01-1003-2	Fixed Block	1
84	30119-01-1004-2	Water Pipe Connector B	1
86	A07003A	Water Pipe Ø6×4×200	1
87	30119-01-1015	Water Pipe Connector A	1
88	30103-01-1037	Start Capacity 75µF	1
88'	30103-02-1037A	Start Capacity 150µF	1'
89	30119-01-1019	Protective Pad	1
90	30119-01-1007	Suction Head	1
91	80402003S	Nut M4	4
92	80301001B	Flat Washer Ø4×9×1	4

## XL 450 FLOOR FINISHING MACHINE

No.	Parts Code	Parts Name	Q'ty
93	30119-01-1010	Fixed Block Holder	1
94	80101030S	Screw M4×25	4
95	80106060S	Screw KA3.5×14	2
96	30101-01-1072	Socket B	1
97	80106056S	Screw PA3×8	2
98	A08008	Splash Guard	1
99	30106-01-3002	Handle Label	1
100	30101-01-3006	Warning Label	1
<b>WATER TANK</b>			
82	30119-01-1017	Nozzle	1
108	30119-01-1020	Watering Pot	1
109	30119-01-1018	Cap	1
110	30119-01-1021	Water Pipe Connector C	1
111	A07003B	Water Pipe Ø6×4×900	1
112	30119-01-1013	Basket	1
113	80102025W	Screw M5×20	4
114	30101-01-1046	Soft Pad B	2
<b>ACCESSORIES</b>			
101	900323	Carpet Brush	1
102	90033	Floor Brush	1
103	90035	Pad Holder	1
104	90094A	Polishing Pad (White)	1
105	90094B	13" Waxing Pad (Red)	1
106	90094C	13" Stripping Pad (Black)	1